

# Installation

## A UNDER BENCH / TOP VENT

### Models WAM25 & WAM25G Warrior Mini Bar Fridge



Fridge Specs: 350mm W x 395mm D x 490mm H  
Cabinet Minimum Internal Width: 380mm

OPTIONAL - Bench Top Vent

Model WAVE300

Avail in Black and Stainless Steel

Dimensions: 100mm D x 300mm W

-  Arrows indicate minimum width / height for airflow
-  Blue arrows indicate airflow ventilation
-  Dark Grey indicate cabinetry & benchtop.

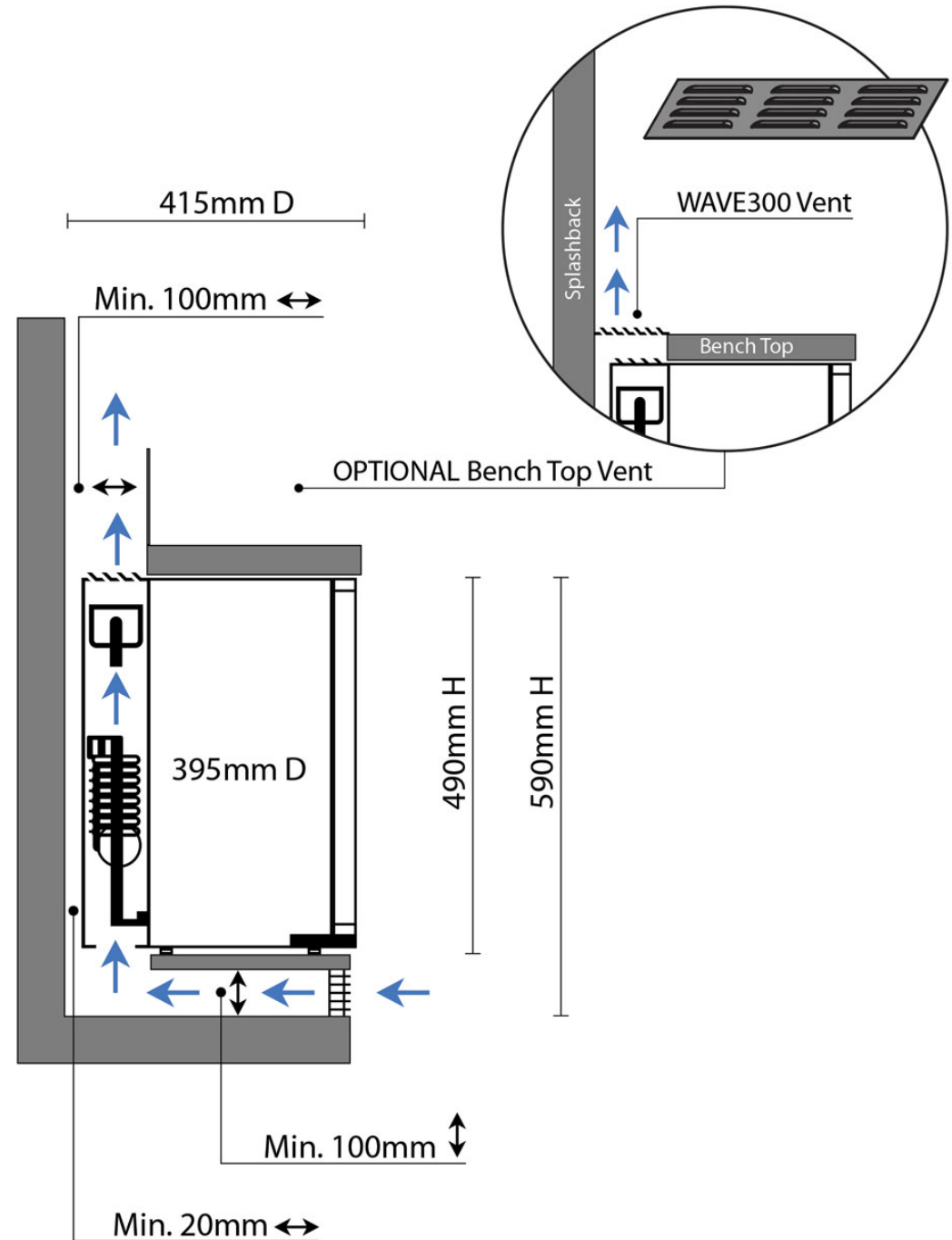

1300 232 616

WARRIORFRIDGES.COM.AU

# Installation

## A UNDER BENCH / TOP VENT

### Model WAVE300 Warrior Louvered Vent

OPTIONAL - Bench Top Vent  
Dimensions: 300mm W x 100mm D  
Fabrication - Stainless Steel

Designed for Integration in Top of Bench to  
Install with Warrior Mini Fridge Models:

WAM25G, WAM25

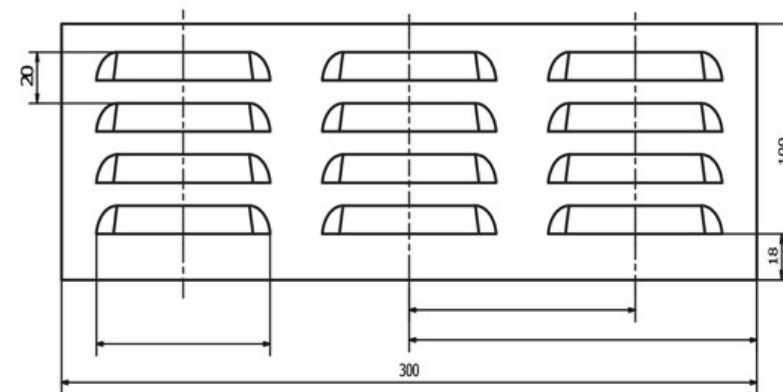
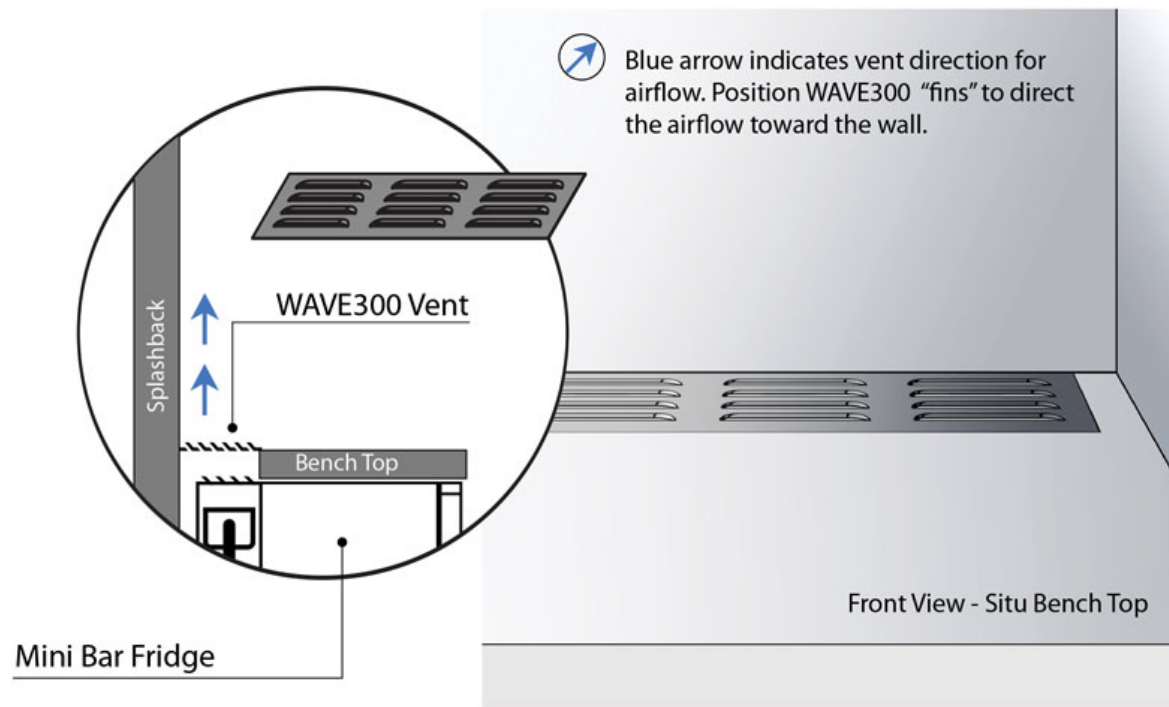

1300 232 616



WARRIORFRIDGES.COM.AU

# Installation

## B ABOVE BENCH / FRONT VENT

### Model WAM25 & WAM25G Warrior Mini Bar Fridge

Fridge Specs: 350mm W x 395mm D x 490mm H  
Cabinet Minimum Internal Width: 380mm

-  Arrows indicate minimum width / height for airflow
-  Blue arrows indicate airflow ventilation
-  Dark Grey indicate cabinetry & benchtop.

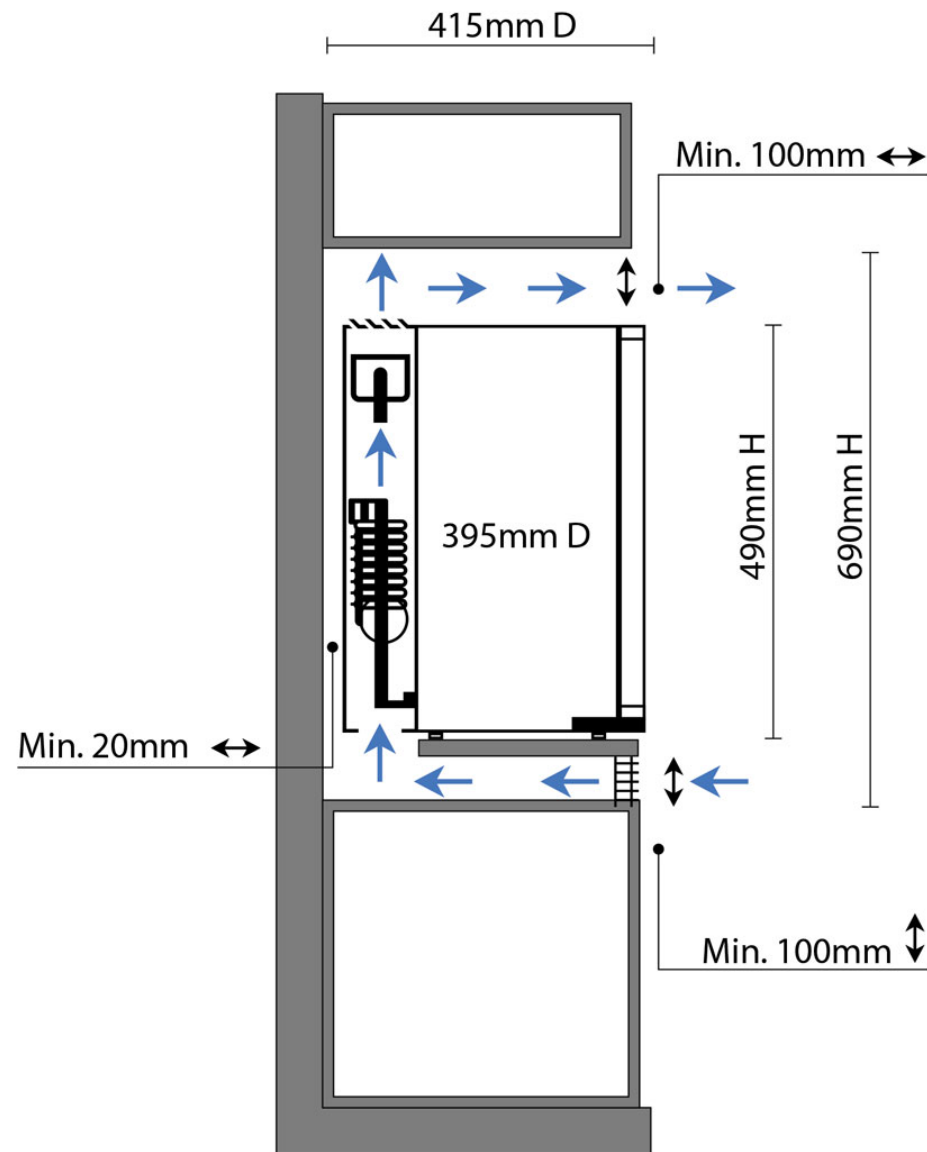

1300 232 616



WARRIORFRIDGES.COM.AU

# Installation

## C ABOVE BENCH / REAR VENT

### Model WAM25G & WAM25 Warrior Mini Bar Fridge

Fridge Specs: 350mm W x 395mm D x 490mm H  
Cabinet Minimum Internal Width: 380mm

-  Arrows indicate minimum width / height for airflow
-  Blue arrows indicate airflow ventilation
-  Dark Grey indicate cabinetry & benchtop.

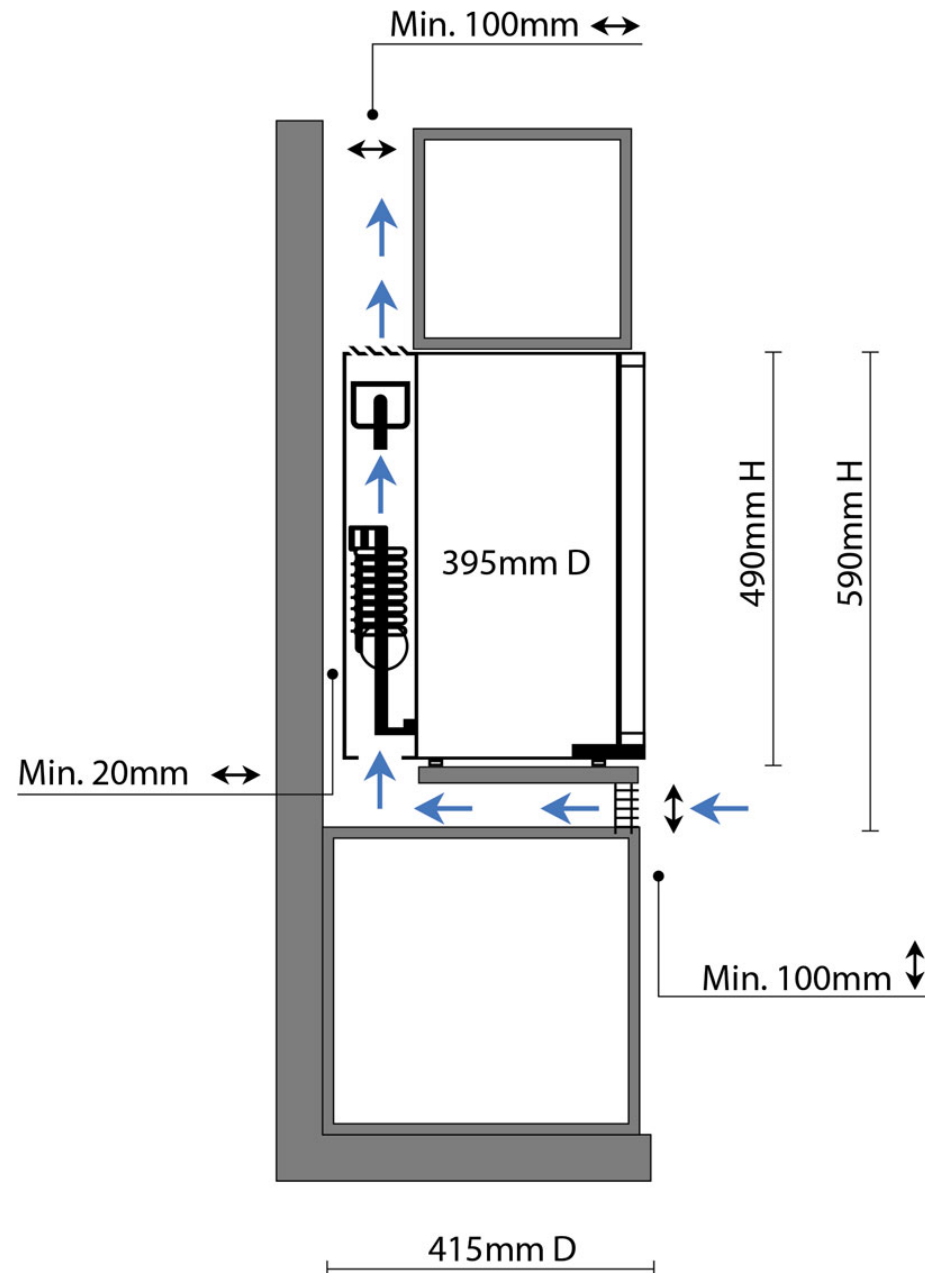

1300 232 616

WARRIORFRIDGES.COM.AU