

# Installation

## A UNDER BENCH / TOP VENT

### Models WAM60 & WAM60G Warrior Mini Bar Fridge



Fridge Specs: 460mm W x 500mm D x 625mm H  
Cabinet Minimum Internal Width: 490mm

OPTIONAL - Bench Top Vent

Model WAVE400

Avail in Black and Stainless Steel

Dimensions: 100mm D x 400mm W

-  Arrows indicate minimum width / height for airflow
-  Blue arrows indicate airflow ventilation
-  Dark Grey indicate cabinetry & benchtop.

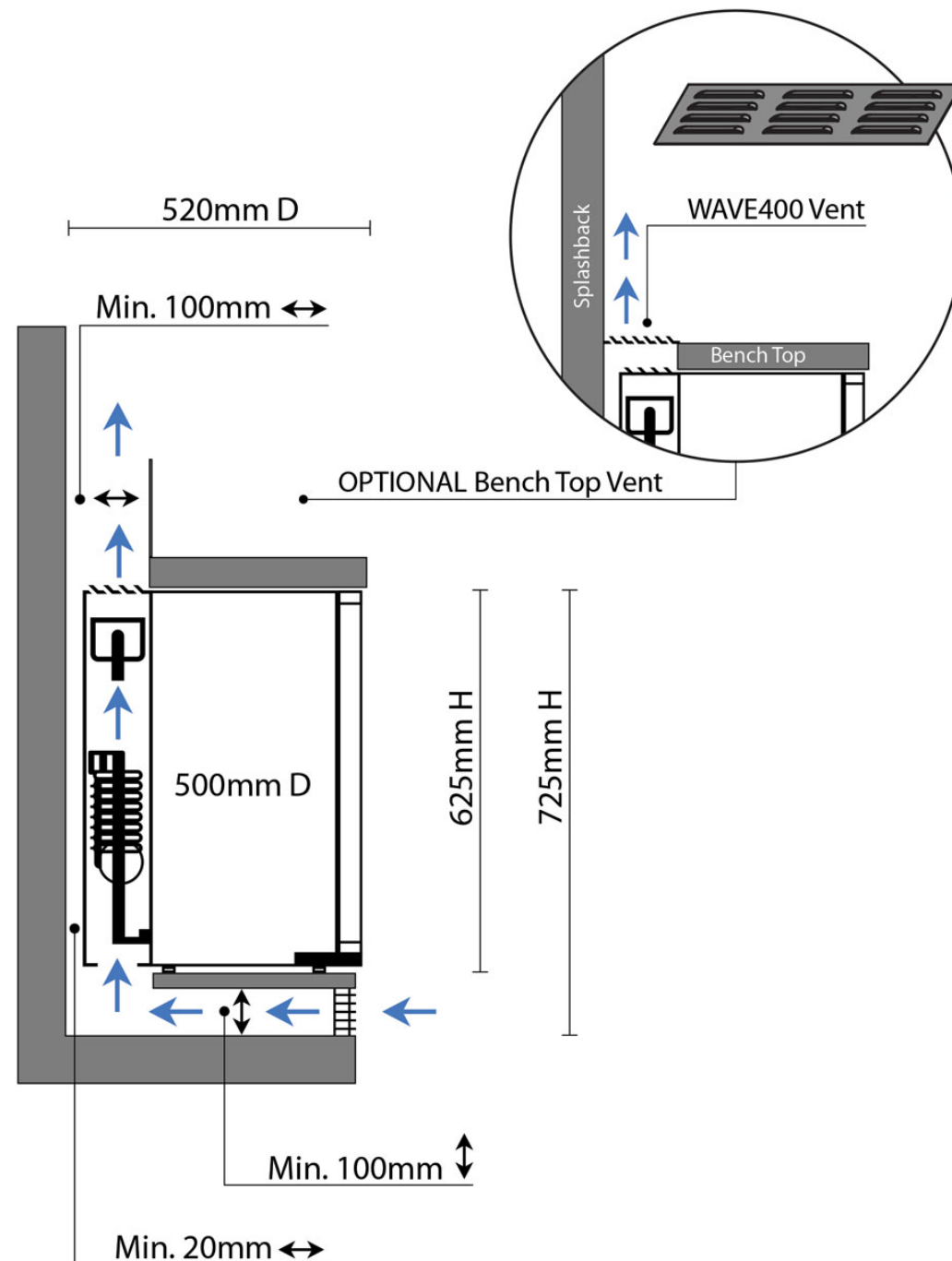

1300 232 616

WARRIORFRIDGES.COM.AU

# Installation

## A UNDER BENCH / TOP VENT

### Model WAVE400 Warrior Louvered Vent

OPTIONAL - Bench Top Vent  
Dimensions: 400mm W x 100mm D  
Fabrication - Stainless Steel

Designed for Integration in Top of Bench to  
Install with Warrior Mini Fridge Models:

WAM60G, WAM60

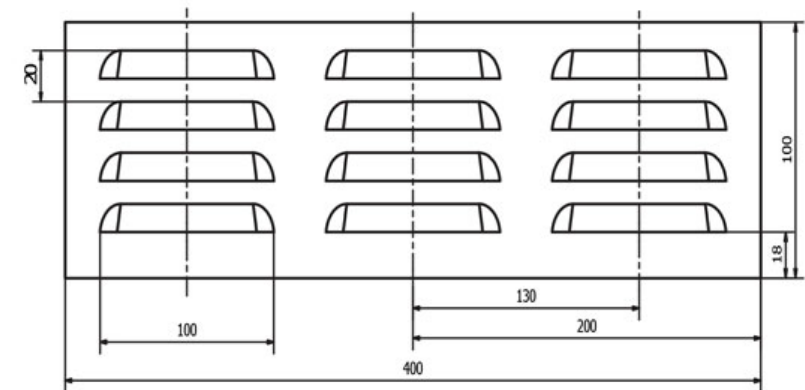
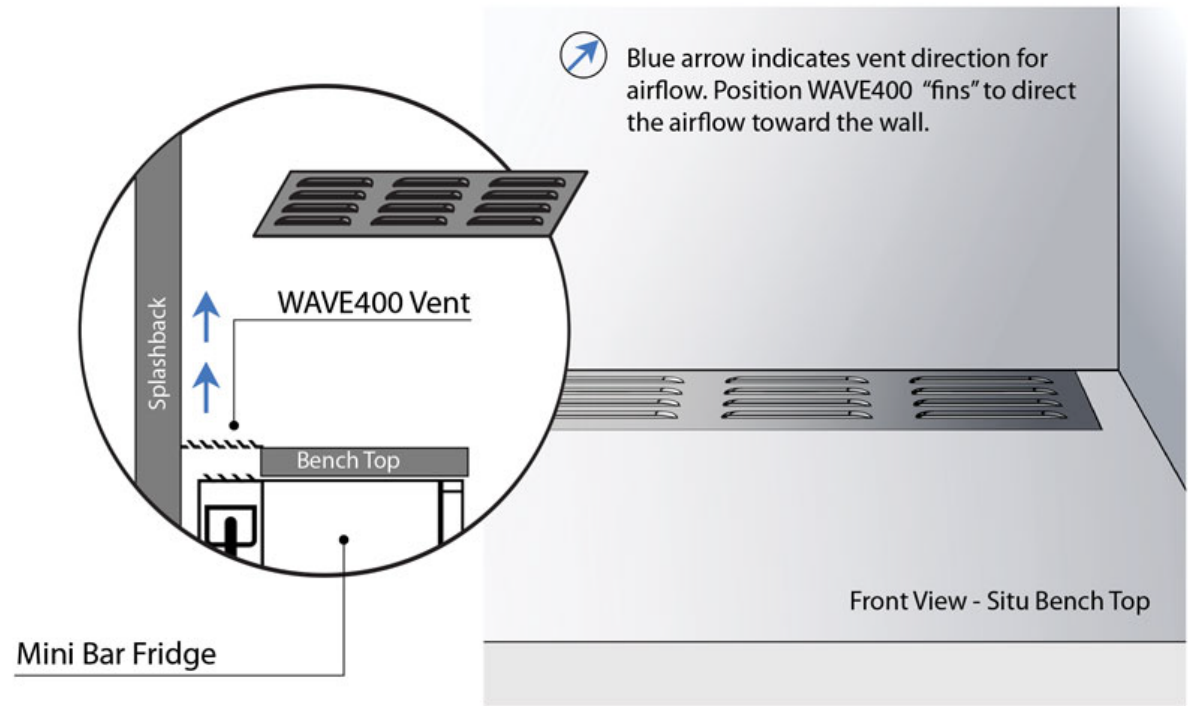

Top Elevation - 100mm x 400mm



1300 232 616



WARRIORFRIDGES.COM.AU

# Installation

## B ABOVE BENCH / FRONT VENT

### Model WAM60 & WAM60G Warrior Mini Bar Fridge

Fridge Specs: 460mm W x 500mm D x 625mm H  
Cabinet Minimum Internal Width: 490mm

-  Arrows indicate minimum width / height for airflow
-  Blue arrows indicate airflow ventilation
-  Dark Grey indicate cabinetry & benchtop.

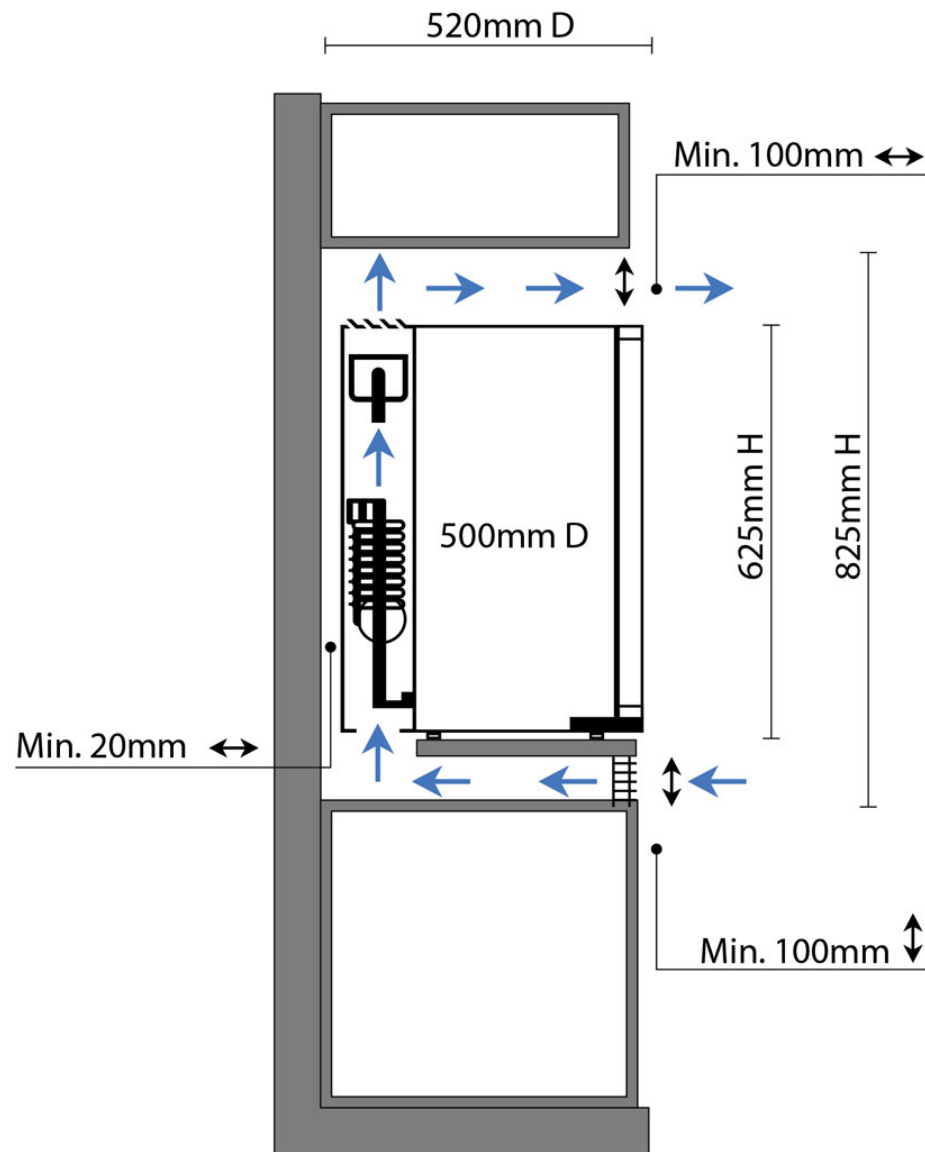

1300 232 616



[WARRIORFRIDGES.COM.AU](http://WARRIORFRIDGES.COM.AU)

# Installation

## C ABOVE BENCH / REAR VENT

### Model WAM60G & WAM60 Warrior Mini Bar Fridge

Fridge Specs: 460mm W x 500mm D x 625mm H  
Cabinet Minimum Internal Width: 490mm

-  Arrows indicate minimum width / height for airflow
-  Blue arrows indicate airflow ventilation
-  Dark Grey indicate cabinetry & benchtop.

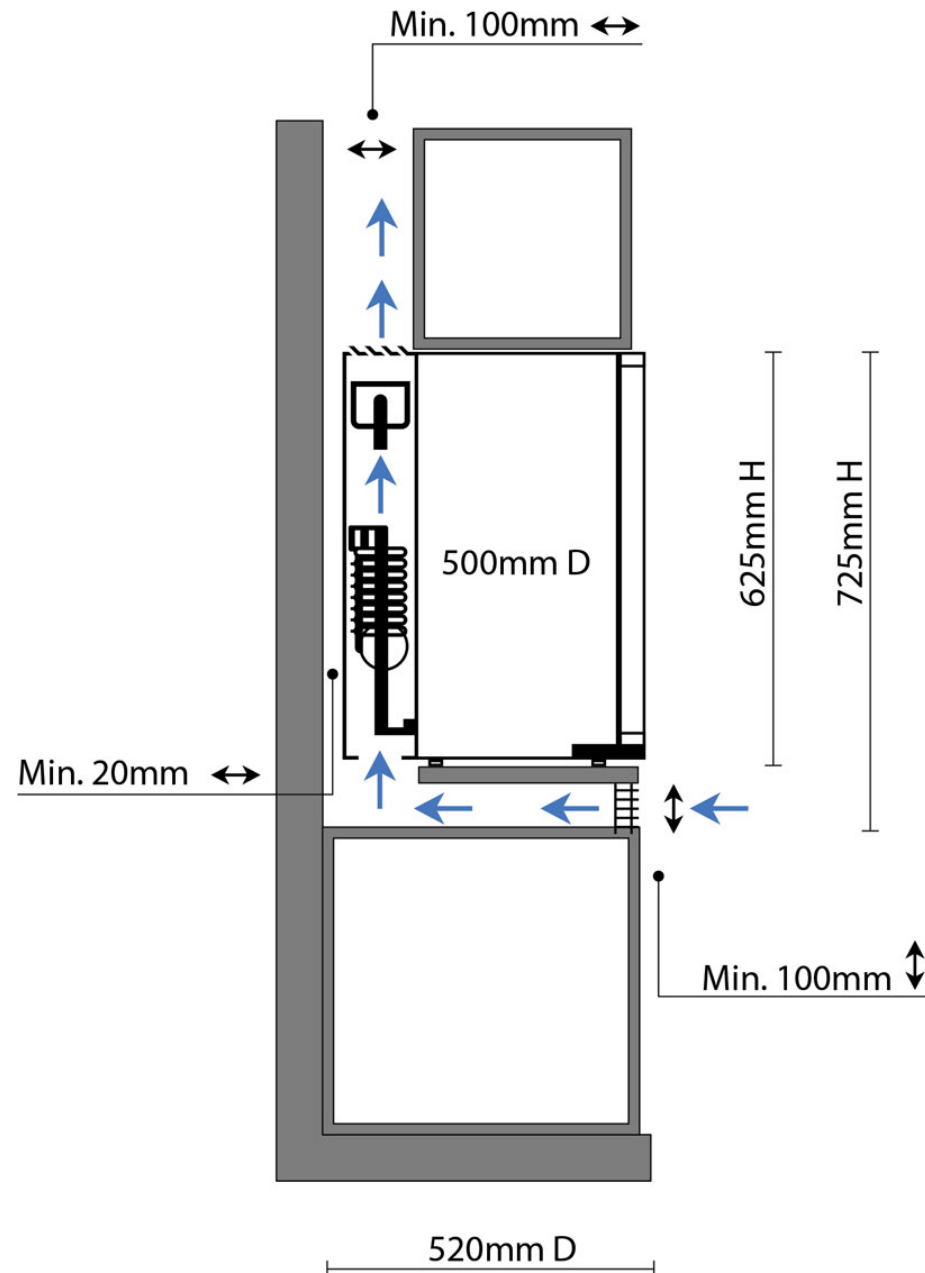

1300 232 616

[WARRIORFRIDGES.COM.AU](http://WARRIORFRIDGES.COM.AU)